

Product Details

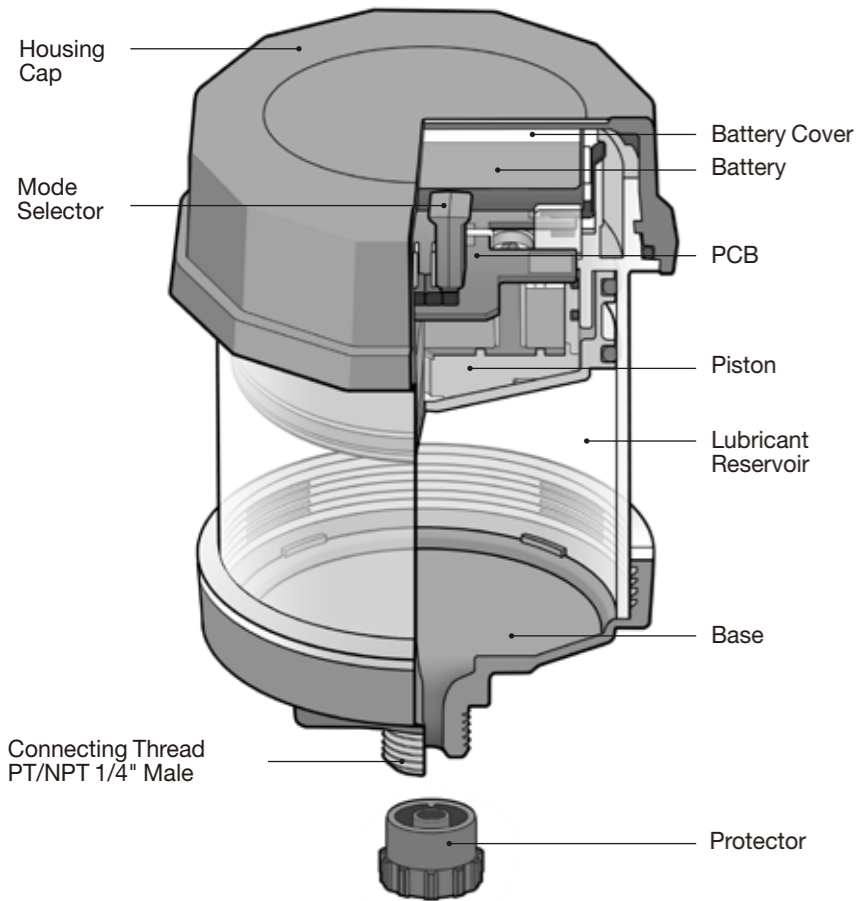

Installation/Disposal Guidelines

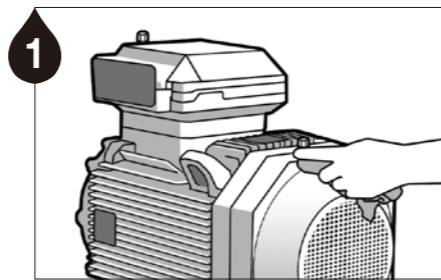

1 Remove contaminants around the lube point.

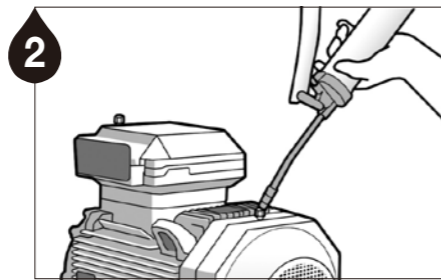

2 Ensure a clear passage using a manual grease gun. **Note 1** Remove any hardened grease by purging the lube point with a manual grease gun. **Note 2** The grease in the equipment and the grease contained in the unit should be the same or compatible.

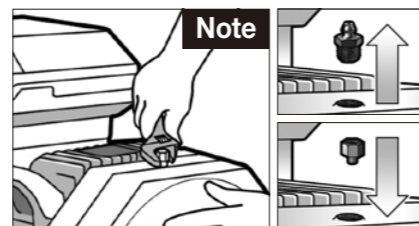

Remove the grease nipple and install appropriate adaptors.

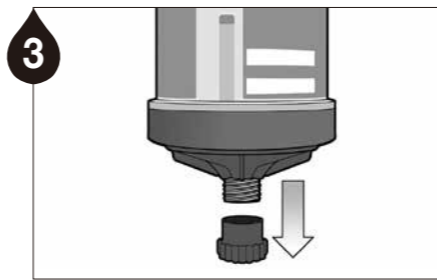

3 Remove the protector.

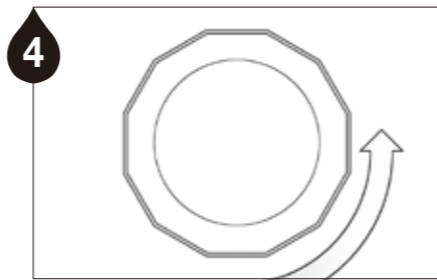

4 Turn the housing cap counterclockwise and unscrew the cap.



5 Pull out the yellow Mode Selector from the default OFF position.

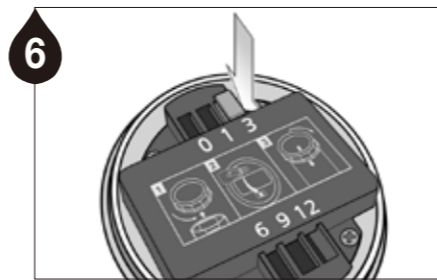

6 Firmly push the Mode Selector into the slot of the desired period.

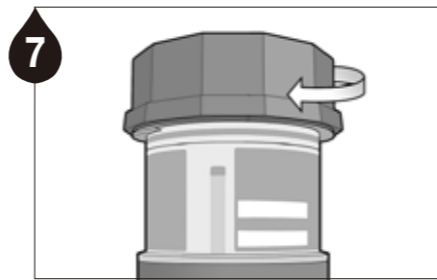

7 Screw the housing cap on the body.

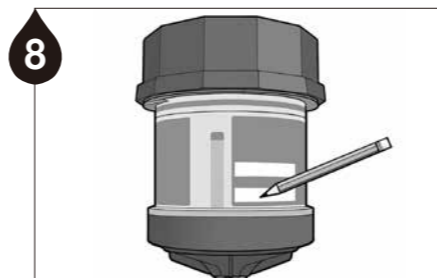

8 Note the installation date and the scheduled date of lube cycle completion on the label of the Lubri-Cup VG Mini. **Note** Please note there is a delay before the actual dispensing starts. It may take up to 1-3 weeks for enough gas to be formed depending on the dispensing setting & installation condition.

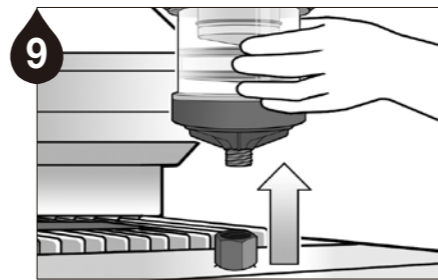

9 When the selected dispensing period of the Lubri-Cup VG Mini has completed, remove the lubricator from the application.

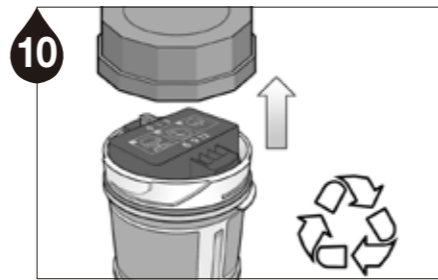

10 The Lubri-Cup VG Mini is an eco-friendly product that can be disposed of separately. Turn the housing cap counterclockwise to disassemble the product for proper disposal.

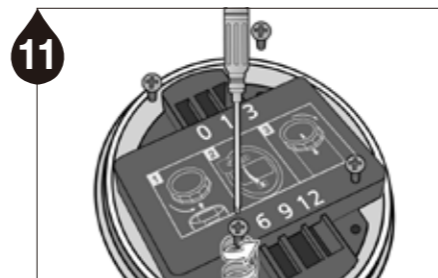

11 Unscrew the screws to remove the battery cover.

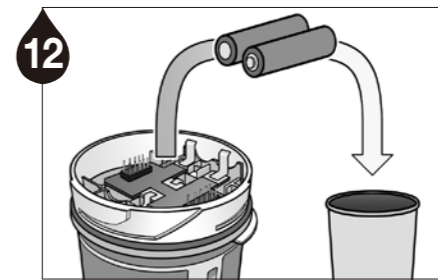

12 Remove the batteries.

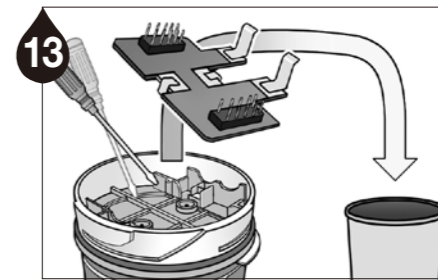

13 Using a hand tool such as a flat-head screwdriver, detach the PCB from the unit.

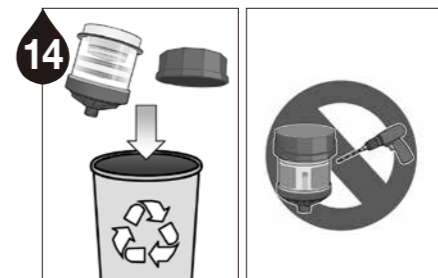

14 Dispose of remaining plastic components complying with local regulations for recycling. **Warning** Do not cut, puncture, or reuse lubricator.

Mounting Installations

High backpressure can cause a delay in dispensing (must be under 5bar).

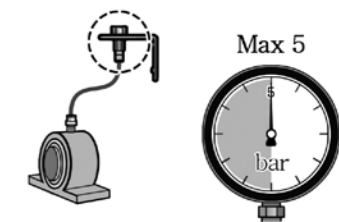

If the product is installed at a 45° or 90° angle, please use an angle adapter with a diameter greater than or equal to 1/4".

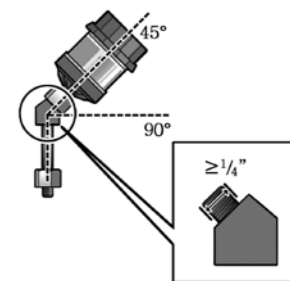

For remote installation using an Ø8 O.D. tubing, keep the maximum distance at 1m (3ft) or less.

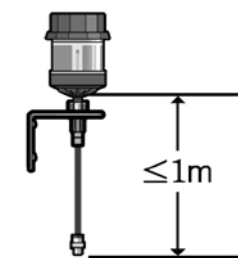



Dispensing Volume Chart

Dispensing Period	Dispensing Volume 120ml
1 month	4.00ml/day
3 month	1.33ml/day
6 month	0.67ml/day
9 month	0.44ml/day
12 month	0.33ml/day

Note

Dispensing volumes (ml/day) are calculated assuming the lubricator is operating at 1 atm (14.7psi), 20°C. Output volume may vary with ambient temperature changes, atmospheric pressure changes, consistency of lubricant, or any resistance or backpressure existing at the lube point (bearing or passage).

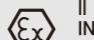
Product Certifications

Certifications		
IECEX	Ex ia IIC T4 Ga IECEX KTL 12.0008X -20°C ≤ Ta ≤ +55°C	IEC 60079-0:2011 IEC 60079-11:2011
ATEX	 0344  II 1 G Ex ia IIC T4 Ga INERIS 12ATEX0062X -20°C ≤ Ta ≤ +55°C	EN 60079-0 : 2012/A11:2013 EN 60079-11 : 2012
KCs	 Ex ia IIC T4 12-KB2BO-0283X -20°C ≤ Ta ≤ +55°C	IP68
UL	 UL LISTED E352761	Cl. I, Div. 1, Gps. A, B, C, D Cl. II, Div. 1, Gps. E, F, G Hazardous locations, intrinsically safe, Exia, Temp. Code T4, -25°C ≤ Ta ≤ +55°C



Approval No. 18-A180003-0
TESTED FOR INTRINSIC SAFETY IN METHANE
-AIR MIXTURES ONLY

Warning

- ▶ Locations : Intrinsically Safe, SÉCURITÉ INTRINSÈQUE, Exia
- ▶ Potential electrostatic charging hazard; clean only with a damp cloth
- ▶ Do not change, replace, or charge battery cells
- ▶ Temp Code T4 : -25°C ≤ Ta ≤ +55°C
- ▶ Substitution of components may impair Intrinsic Safety : AVERTISSEMENT : LA SUBSTITUTION DE COMPOSANTS PEUT OMPROMETTRE LA SÉCURITÉ INTRINSÈQUE
- ▶ If ignitable gasses are present, touch only with an insulating object or while wearing an electrostatic grounding device
- ▶ To prevent ignition of flammable or combustible atmospheres, read, understand, and adhere to manufacturer's live maintenance procedure
- ▶ The batteries are not user-replaceable

Mounting Methods

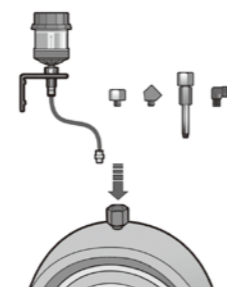

The Lubri-Cup VG Mini is designed for single point lubrication only. Direct mount is recommended. For applications not allowing any direct mounts, remotely mount the unit using appropriate accessories and keep the distance from the lube point as short as possible.

For remote installation using a tube, use an Ø8 O.D. (5/16") tubing pre-filled with the same or compatible grease as the grease contained in the unit.

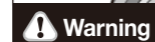

If excessive backpressure exists at the lube point, grease may escape at the base of the unit as a visual warning.

Warning This product is a disposable unit. Please replace with a new unit once set dispensing period has completed.



CHESTERTON
Global Solutions, Local Service.

A.W. Chesterton Company

860 Salem Street, Groveland, MA 01834, USA

© 2019 A.W. Chesterton Company.

® Registered trademark owned and licensed by A.W. Chesterton Company in USA and other countries, unless otherwise noted. www.arc-epc.com

A.W. Chesterton Company makes no representations or warranties with respect to the completeness or accuracy of the data or information contained herein. A.W. Chesterton does not assume any liability for any losses or damages resulting from the use or application of the data or information contained herein. Application conditions may influence the outcome of the usage of the product. For specific guidance concerning usage and application conditions, please contact AWC IL/MRO Application Engineering at 978 469 2400.



User Manual

LUBRI-CUP™
VG Mini
(120ml)